

Congratulations on choosing the **patented KeyPack[®] system** for the transport of **biological** and/or **infectious material**. Follows a brief guide to use it in accordance with the law and in complete safety.

■ COMPONENTS

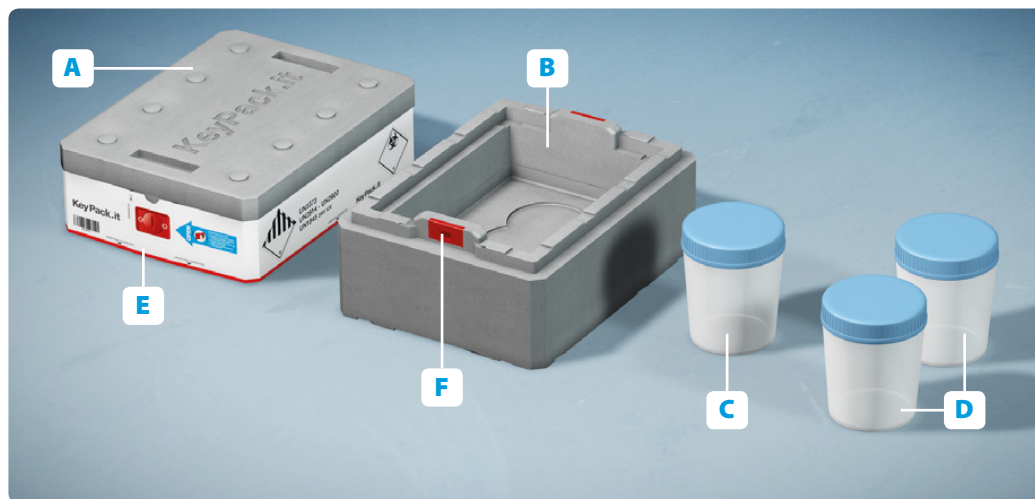

- A. n.1 EPS lid.
- B. n.1 EPS box.
- C. n.1 jam.
or
- D. n.2 jars.
- E. Band.
- F. Lock system.

■ ASSEMBLY

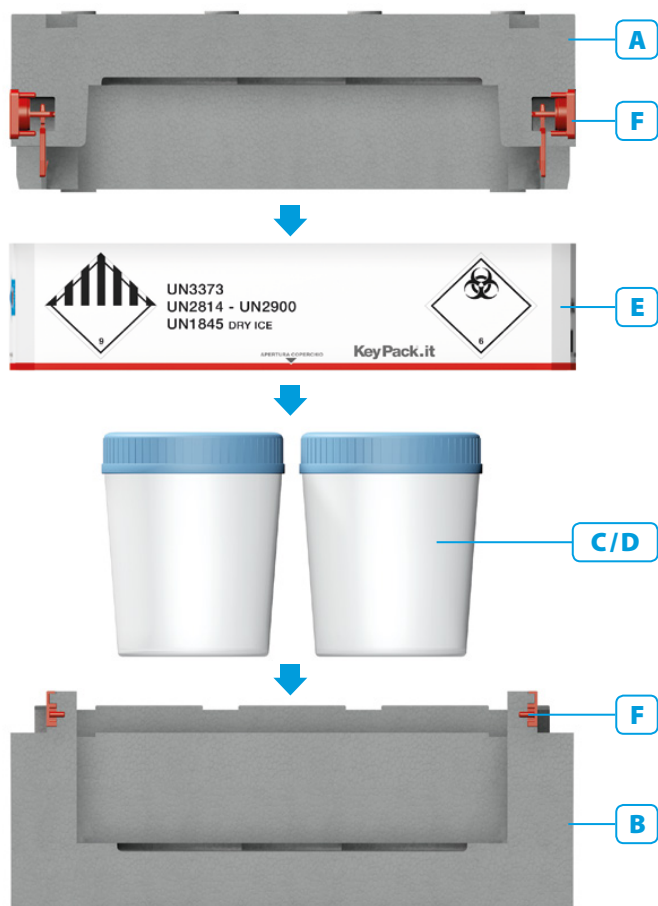

Suitability for the following transport routes

